

Solar

User / Installation Manual

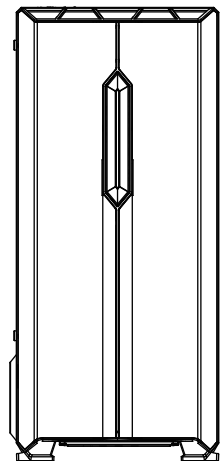

Rev 1.0 (2018-A1-10)



0

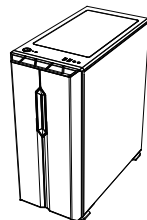

- A: Removal of the front and side panels
- B: Installation of the power supply (PSU)
- C: Installation of the motherboard
- D: Installation of fan(s) and/or radiator(s)
- E: Installation of 3.5" HDDs
- F: Installation of 2.5" HDDs or SSDs
- G: Installing PCI / PCI-e card(s) and removing the expansion slot covers

Accessory bag



C

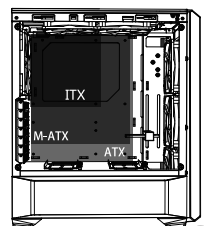

- Ensure the copper mounting points are situated at the correct position for your motherboard, and secure with mounting screws (No.3).
- Note: Additional copper mounting points are provided if required.



A

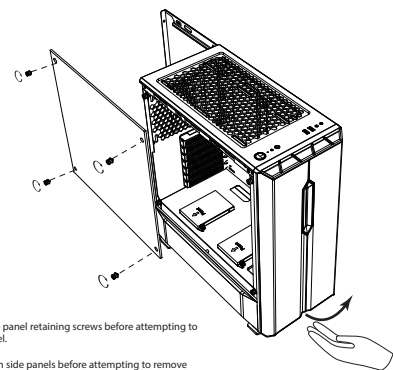

- Remove side panel retaining screws before attempting to remove panel.
- Remove both side panels before attempting to remove the front panel.

B

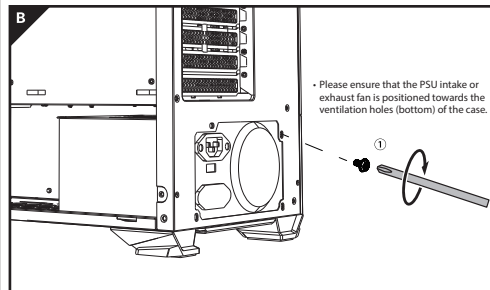

- Please ensure that the PSU intake or exhaust fan is positioned towards the ventilation holes (bottom) of the case.

D

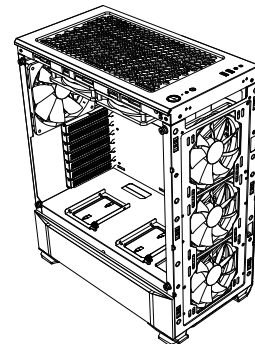

Fan Support:

Front: 3 x 120mm
Top: 2 x 120mm
Rear: 1 x 120mm

Water Cooling Radiator Support:

Front: 1 x 240mm or 1 x 360mm
Top: 1 x 240mm
Rear: 1 x 120mm

E

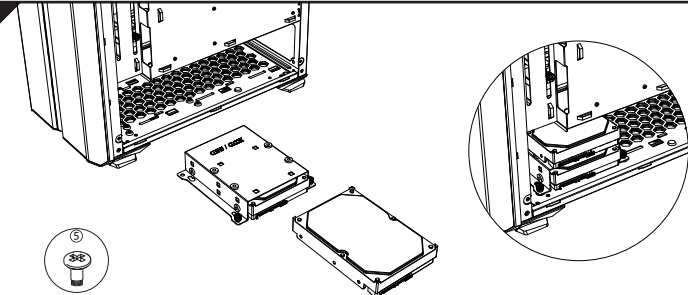

- Unscrew and remove HDD enclosure.
- Install first 3.5" HDD on the top of the enclosure, and secure with screws provided (No.4).
- Install additional 3.5" HDD into the enclosure(s).
- Insert enclosure into the case and secure with thumbscrews.

F

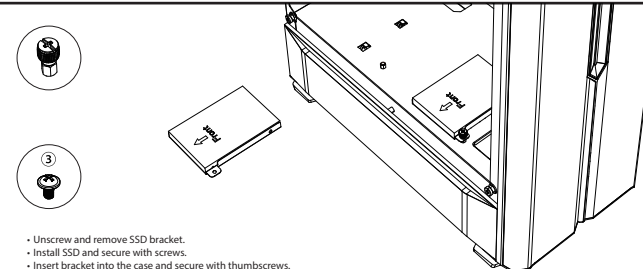

- Unscrew and remove SSD bracket.
- Install SSD and secure with screws.
- Insert bracket into the case and secure with thumbscrews.

G

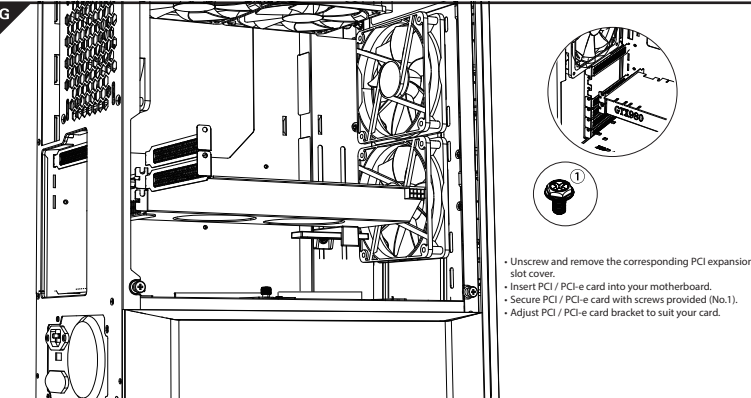

- Unscrew and remove the corresponding PCI expansion slot cover.
- Insert PCI / PCI-e card into your motherboard.
- Secure PCI / PCI-e card with screws provided (No.1).
- Adjust PCI / PCI-e card bracket to suit your card.

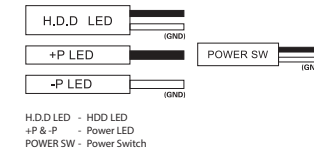

H.D.D LED - HDD LED
+P & -P - Power LED
POWER SW - Power Switch

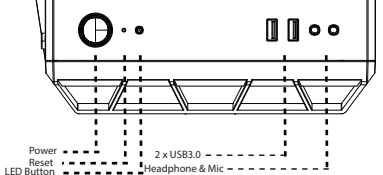

Should you have any problems with your purchase, please contact your place of purchase. If they are unable to help, please visit www.gamemax.uk, and use the contact us section, using the applicable form. Please include the following: Product Model Number, Serial Number, Date of Purchase, Place of Purchase, Detailed Fault.

At the end of this products servicable life, DO NOT dispose of with household waste, please recycle where facilities exist. Check with your local authority for recycling advice.

*Specifications and information are subject to change without prior notice



© 2018 Game Max UK. All rights reserved. Game Max UK, Hardware House, James Street, Bury, Lancs. BL9 7EG. United Kingdom
All other registered trademarks belong to their respective companies. www.gamemax.uk

Imported into the UK by: GameMax UK, Hardware House, James Street, Bury, Lancs. BL9 7EG. United Kingdom.